

Fixings you can really trust

**ONE PLUG
MANY TASKS**

PLASTIC PLUG

PLASTIC PLUG (PVC)



All Purpose cost effective fixing for medium & lightweight application.

Description

All purpose cost effect fixing for medium and lightweight application.

Features and benefits

- Suitable for wood and chipboard screws.
- M-teeth combined with side-links and screw-guide; ensure entire plug face is forced against walls of hole, for enhanced grip in soft materials.
- The wide neck is subject to no expansion pressure and prevents surface damage to tiles and plaster.
- Side-links stop plug from breaking open during insertion, ensuring positive action when screw is driven in.
- Offset block profile allows plug to hold firmly against sides of hole when expansion begins.

Applications

- Pictures • Lightening • Skirting • Shelves • Trunking • Cable Trays • Electrical Fitting

Installation

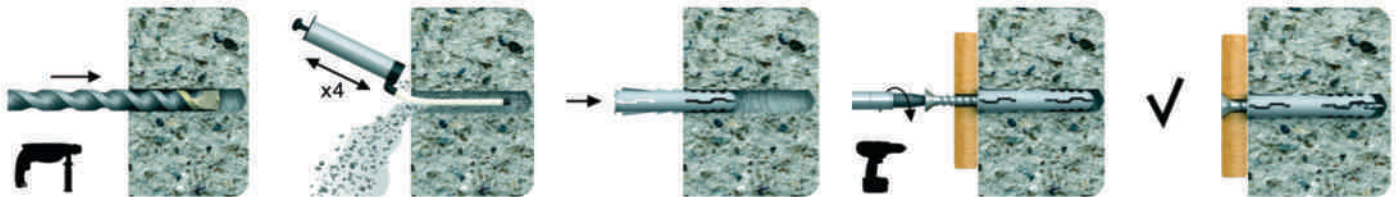

1. Drill a hole of required diameter.
2. Clean the drilled hole by blow pump.
3. Insert the plastic plug into the hole & tap.
4. Insert screw of required diameter into plug through fixture & tighten.

PLASTIC PLUG PVC WITHOUT SCREW

Product	Hole Diam. (mm)	Length (mm)	Product Image
P25	05	25	
P35	05	35	
P38	05	40	
I-6	06	30	
I-8	08	40	
I-10	10	50	
I-12	12	55	
I-14	14	75	

PLASTIC PLUG PVC WITH SCREW

Product	Size In (mm)
PVC 880	8X80
PVC 8100	8X100
PVC 8120	8X120
PVC 10100	10X100
PVC 10120	10X120
PVC 10140	10X140
PVC 10160	10X160

Base material

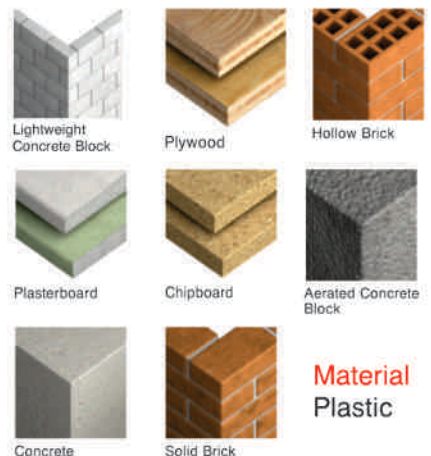

Material Plastic

